

A1 0 1 2 3 4 5 6 7 8 9 10

NOT FOR CONSTRUCTION

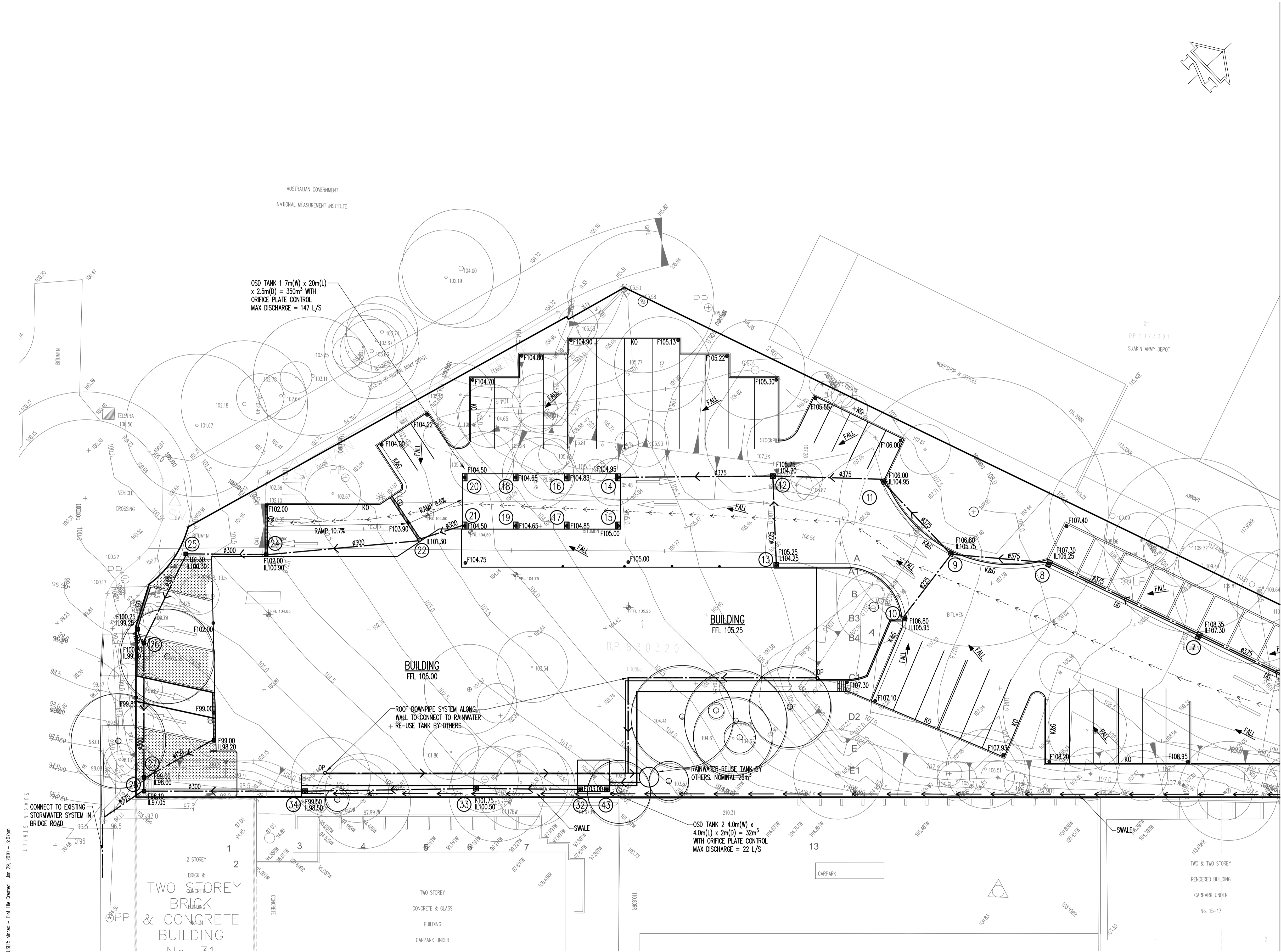

FOR CONTINUATION REFER TO DRAWING N6C03

NOT FOR CONSTRUCTION

A1 1 2 3 4 5 6 7 8 9 10

Rev	Description	Eng	Draft	Date	Rev	Description	Eng	Draft	Date	Rev	Description	Eng	Draft	Date
P2	REVISED FOR DA	SC	VC	29.01.10										
P1	DEVELOPMENT APPLICATION	SC	VC	30.10.09										

Architect  
CALDISCOOK  
L2, 45 CHIPPEN STREET, CHIPPENDALE

**TaylorThomsonWhitting**  
Consulting Engineers  
48 Chandos Street St Leonards NSW 2065  
T: +61 2 9439 7288 F: +61 2 9439 3146 ttwsyd@ttw.com.au  
Taylor Thomson Whitting (NSW) Pty Ltd A.C.N. 113 578 377

Project  
WORKS DEPOT  
5 SUAKIN STREET, PYMBLE

Sheet Subject  
SITeworks PLAN 1

Scale : A1 1:250	Drawn VC	Authorised —
Job No 081712	Drawing No C02	Revision P2
Plot File Created: Jan 29, 2010 - 3:07pm		

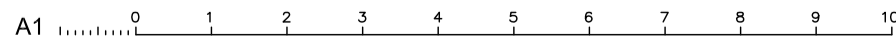

Architect  
**CALDISCOOK**  
L2, 45 CHIPPEN STREET, CHIPPENDALE



Sheet Subject	SITEWORKS PLAN 2
---------------	------------------

Scale : A1	Drawn	Authorised
1:250	VC	—
Job No	Drawing No	Revision
081712	C03	P2
Plot File Created: Jan 29, 2010 - 3:07pm		

NOT FOR CONSTRUCTION

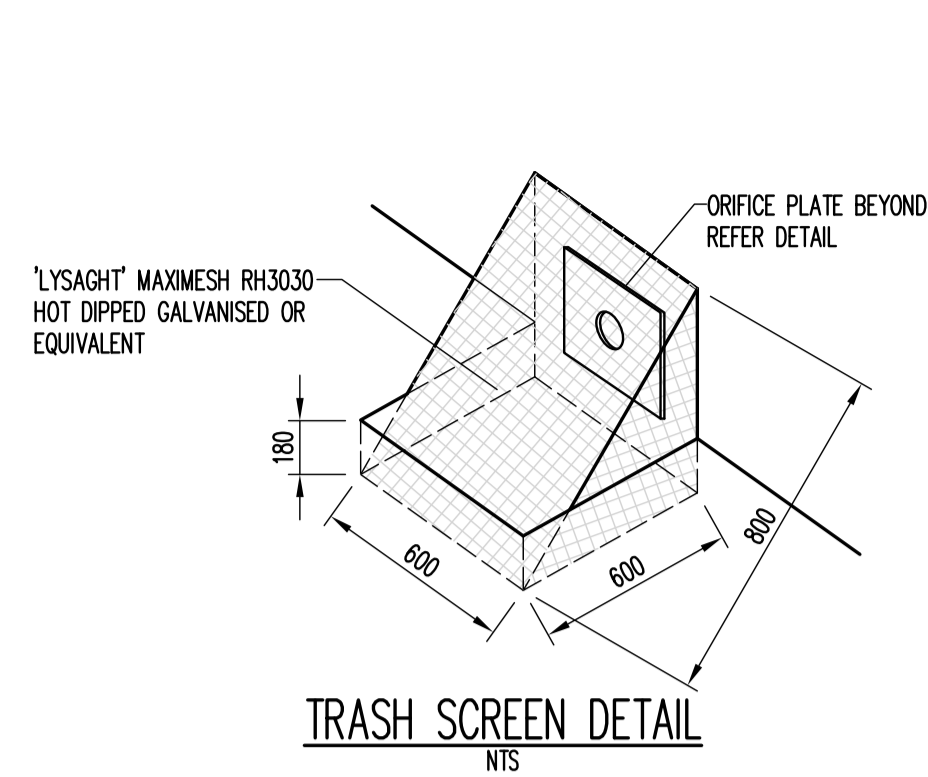
[illegible]

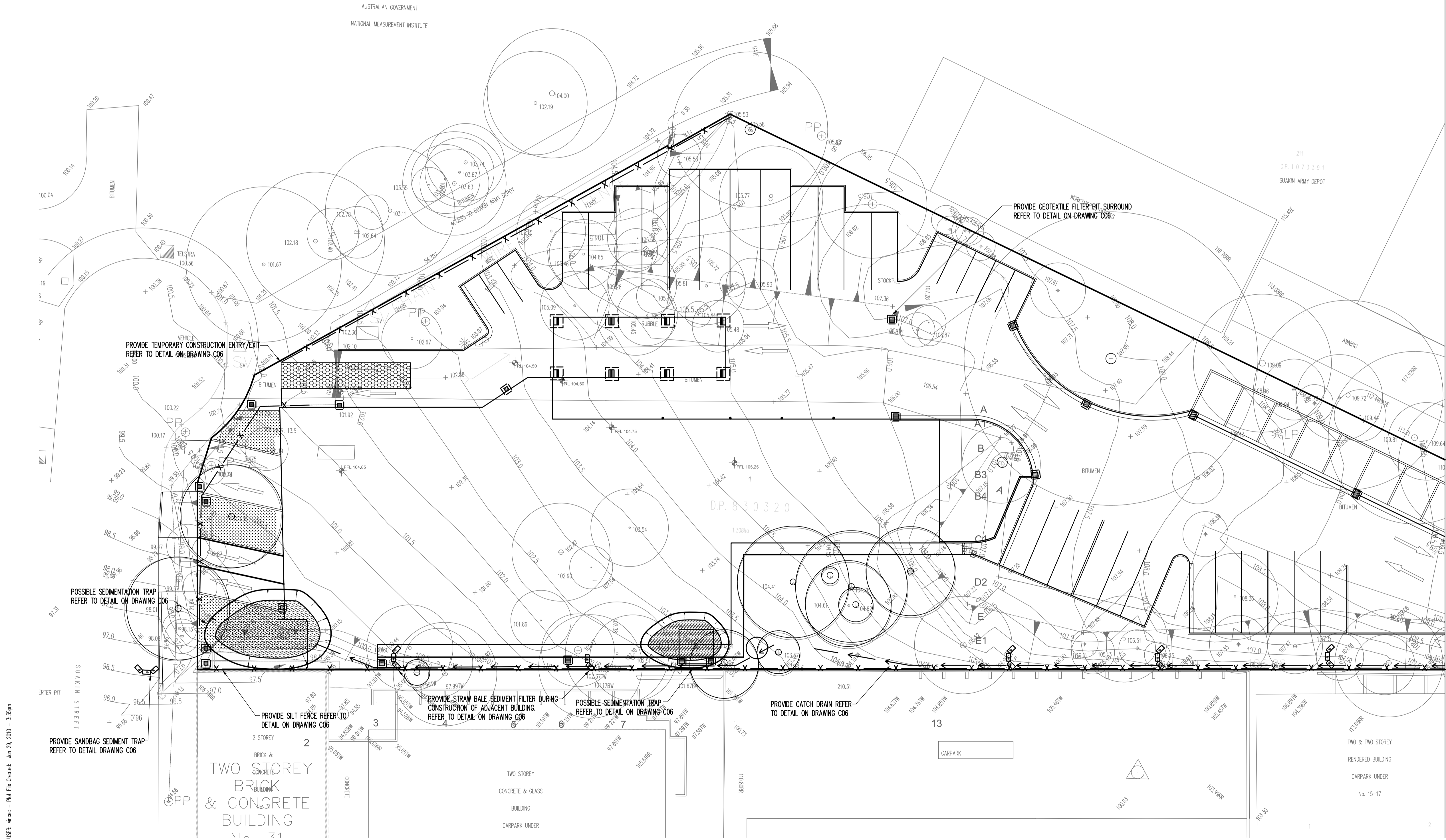

EROSION AND SEDIMENT CONTROL NOTES

- All work shall be generally carried out in accordance with:
  - Local authority requirements; Water management development control plan (DCP 47)
  - EPA - Pollution control manual for urban stormwater,
  - Department of conservation and land management manual- "Urban Erosion & Sediment Control".
- Erosion and sediment control **drawings and notes** are provided for the whole of the works. Should the Contractor stage these works then the design may require to be modified. Variation to these details may require to be approved by the relevant authorities. The erosion and sediment control **plan** shall be implemented and adapted to meet the varying situations as work on site progresses.
- Maintain all erosion and sediment control devices to the satisfaction of the superintendent and the local authority.
- When stormwater pits are constructed prevent site runoff entering the pits unless silt fences are erected around pits.
- Minimise the area of site being disturbed at any one time.
- Protect all stockpiles of materials from scour and erosion. Do not stockpile loose material in roadways, near drainage pits or in watercourses.
- All soil and water control measures are to be put back in place at the end of each working day, and modified to best suit site conditions.
- Control water from upstream of the site such that it does not enter the disturbed site.
- All construction vehicles shall enter and exit the site via the temporary construction entry/exit.
- All vehicles leaving the site shall be cleaned and inspected before leaving.
- Maintain all stormwater pipes and pits clear of debris and sediment. Inspect stormwater system and clean out after each storm event.
- Clean out all erosion and sediment control devices after each storm event.

Sequence of Works

- Prior to commencement of excavation the following soil management devices must be installed.
  - Construct silt fences below the site and across all potential runoff sites.
  - Construct temporary construction entry/exit and divert runoff to suitable control systems.
  - Construct measures to divert upstream flows into existing stormwater system.
  - Construct sedimentation traps/basin including outlet control and overflow.
  - Construct turf lined swales.
  - Provide sandbag sediment traps upstream of existing pits.
- Construct geotextile filter pit surround around all proposed pits as they are constructed.
- On completion of pavement provide sand bag kerb inlet sediment traps around pits.
- Provide and maintain a strip of turf on both sides of all roads after the construction of kerbs.

EROSION AND SEDIMENT CONTROL LEGEND

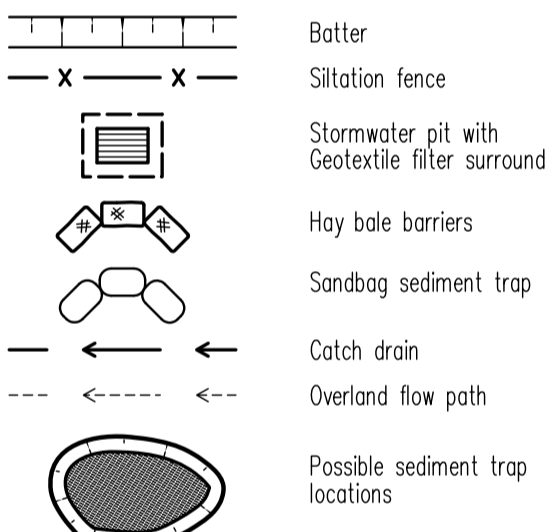

Total sedimentation trap storage required based on disturbed area of 1.0ha is 246m<sup>3</sup>.  
Note: Staging works to reduced disturbed area can reduce sedimentation trap storage requirements.

NOT FOR CONSTRUCTION

Filename: C05.dwg - USER: mace - Plot File Created: Jan 29, 2010 - 3:35pm

A1 1 2 3 4 5 6 7 8 9 10

Rev	Description	Eng	Draft	Date	Rev	Description	Eng	Draft	Date	Rev	Description	Eng	Draft	Date
P2	REVISED FOR DA	SC	VC	29.01.10										
P1	DEVELOPMENT APPLICATION	SC	VC	19.11.09										

Architect  
CALDISCOOK  
L2, 45 CHIPPEN STREET, CHIPPENDALE



TaylorThomsonWhitting  
Consulting Engineers  
48 Chandos Street St Leonards NSW 2065  
T: +61 2 9439 7288 F: +61 2 9439 3146 ttwsyd@ttw.com.au  
Taylor Thomson Whitting (NSW) Pty Ltd A.C.N. 113 578 377

Project  
WORKS DEPOT  
5 SUAKIN STREET, PYMBLE

Sheet Subject  
SEDIMENT AND EROSION  
CONTROL PLAN 1

Scale	Drawn	Authorised
A1 1:250	VC	—
Job No	Drawing No	Revision
081712	C05	P2
Plot File Created: Jan 29, 2010 - 3:35pm		



NOT FOR CONSTRUCTION

P2	REVISED FOR DA	SC	VC	29.01.10
----	----------------	----	----	----------

Year	2000	2001	2002	2003	2004	2005	2006	2007	2008	2009	2010	2011	2012	2013	2014	2015	2016	2017	2018	2019	2020	2021	2022	2023	2024	2025	2026	2027	2028	2029	2030	2031	2032	2033	2034	2035	2036	2037	2038	2039	2040	2041	2042	2043	2044	2045	2046	2047	2048	2049	2050	2051	2052	2053	2054	2055	2056	2057	2058	2059	2060	2061	2062	2063	2064	2065	2066	2067	2068	2069	2070	2071	2072	2073	2074	2075	2076	2077	2078	2079	2080	2081	2082	2083	2084	2085	2086	2087	2088	2089	2090	2091	2092	2093	2094	2095	2096	2097	2098	2099	2100
------	------	------	------	------	------	------	------	------	------	------	------	------	------	------	------	------	------	------	------	------	------	------	------	------	------	------	------	------	------	------	------	------	------	------	------	------	------	------	------	------	------	------	------	------	------	------	------	------	------	------	------	------	------	------	------	------	------	------	------	------	------	------	------	------	------	------	------	------	------	------	------	------	------	------	------	------	------	------	------	------	------	------	------	------	------	------	------	------	------	------	------	------	------	------	------	------	------	------	------	------	------

Test Assumption	Eng	Span	Port	Test Assumption	Eng	Span	Port
-----------------	-----	------	------	-----------------	-----	------	------

Architect  
**CALDISCOOK**  
L2, 45 CHIPPEN STREET, CHIPPENDALE



Project  
WORKS DEPOT  
5 SUAKIN STREET, PYMBLE

Sheet Subject	SEDIMENT AND EROSION CONTROL PLAN 2
---------------	--

Scale : A1	Drawn	Authorised
1:250	VC	—
Job No	Drawing No	Revision
081712	C06	P2
Plot File Created: Jan 29, 2010 - 3:09pm		



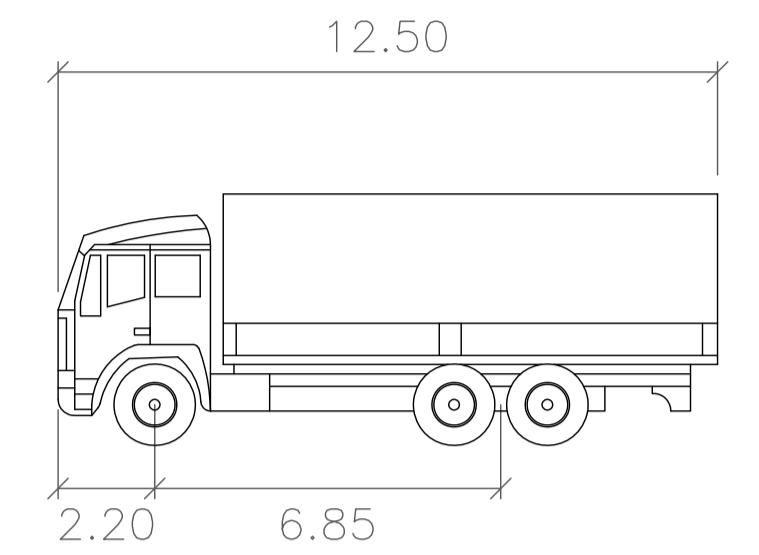

12.5m TRUCK – INTO LOADING AREA 1  
SCALE 1: 200



A1 0 1 2 3 4 5 6 7 8 9 10

P2	REVISED FOR DA				SC	VC	29.01.10										
P1	ISSUE FOR APPROVAL				SC	KH	13.11.09										
Rev	Description	Eng	Draft	Date	Rev	Description	Eng	Draft	Date	Rev	Description	Eng	Draft	Date			

TTW

Project	WORKS DEPOT 5 SUAKIN STREET, PYMBLE
---------	--

Scale : A1                      Drawn                      Authorised

Plot File Created: Jan 29, 2010 - 4:45pm

NOT FOR CONSTRUCTION

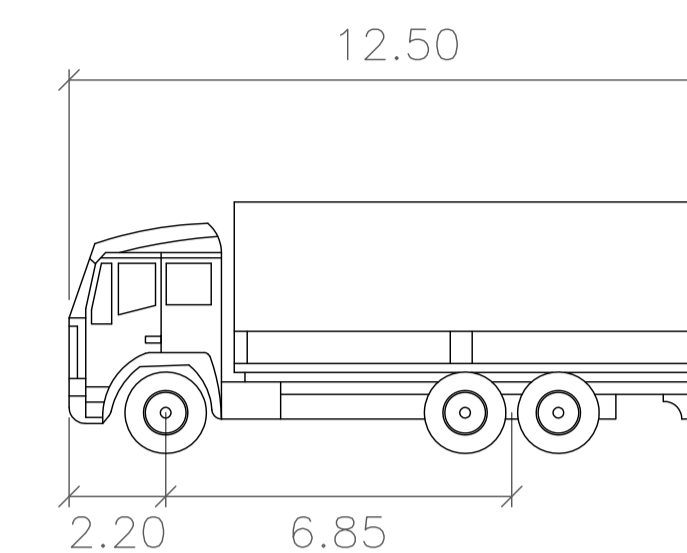
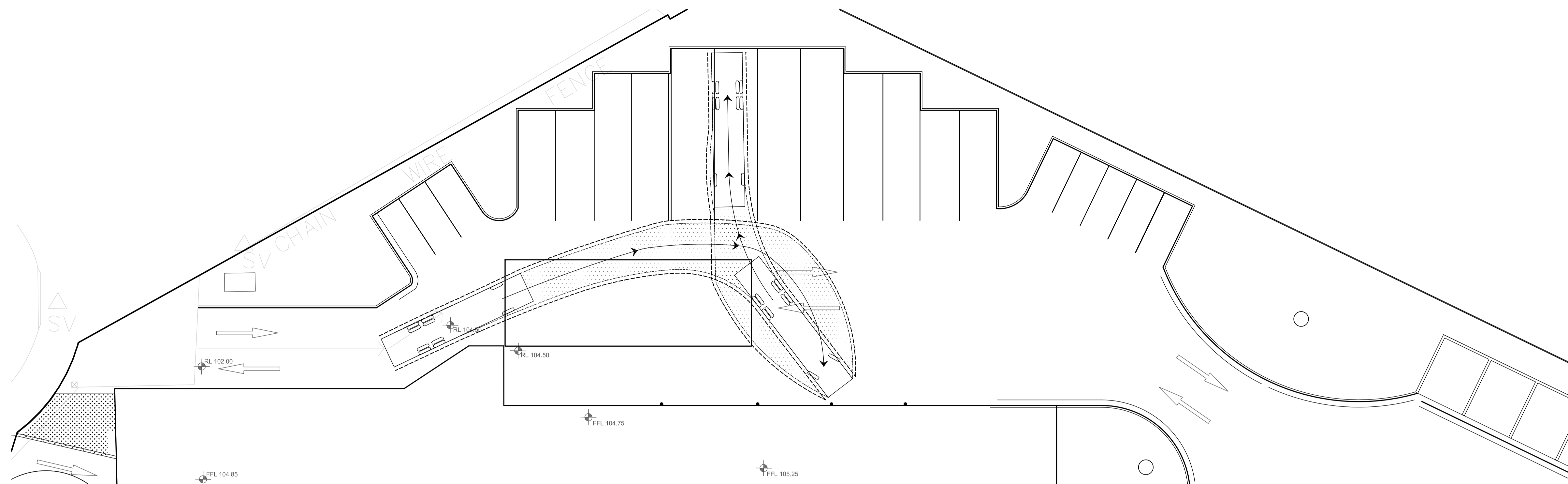

SU TRUCK	meters
Width	: 2.50
Track	: 2.50
Lock to Lock Time	: 6.00
Steering Angle	: 36.6

12.5m TRUCK – INTO PARKING SPACE  
SCALE 1: 200

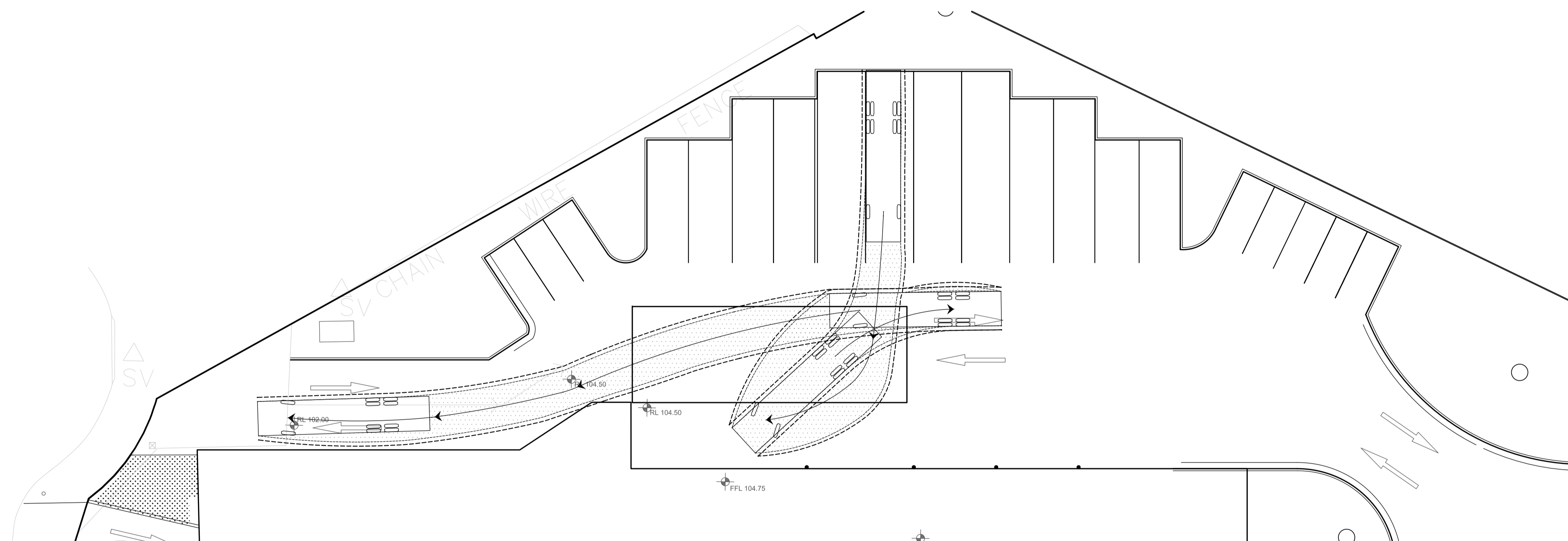

12.5m TRUCK – OUT OF PARKING SPACE  
SCALE 1: 200

FileName: SK003.dwg - USER: vincec - Plot File Created: Jan 29, 2010 - 4:44pm

NOT FOR CONSTRUCTION

<p>A1 ..... 1 2 3 4 5 6 7 8 9 10</p>									
<p>Architect <b>CALDISCOOK</b> L2, 45 CHIPPEN STREET, CHIPPENDALE</p>									
<p>Project <b>WORKS DEPOT</b> 5 SUAKIN STREET, PYMBLE</p>									
<p>Sheet Subject <b>TURNING PATH PLAN SHEET 3</b></p>									
<p>Scale : A1 Drawn Authorised AS SHOWN KH .</p>									
<p>Job No Drawing No Revisor <b>081712 SKC03 P2</b></p>									
<p>Plot File Created: Jan 29, 2010 - 4:44pm</p>									